

QS100 IN-LINE IRRIGATION FLOW SENSOR

The **FLOMEC® QS100 Flow Sensor** is an economical and easy-to-use flow sensor designed for residential and commercial irrigation and sub-metering applications. Utilizing ultrasonic technology, the QS100 provides flow ranges of 0.22-33 GPM. This wide turndown (150:1 turndown ratio) makes it possible to accurately monitor all of your zones from small drips (minimum flow of 0.22 GPM detectable) to large sprayer applications. The meter can also detect small leaks. The QS100 is 100% maintenance-free with no moving parts and won't be damaged by debris and wintertime blowdowns.

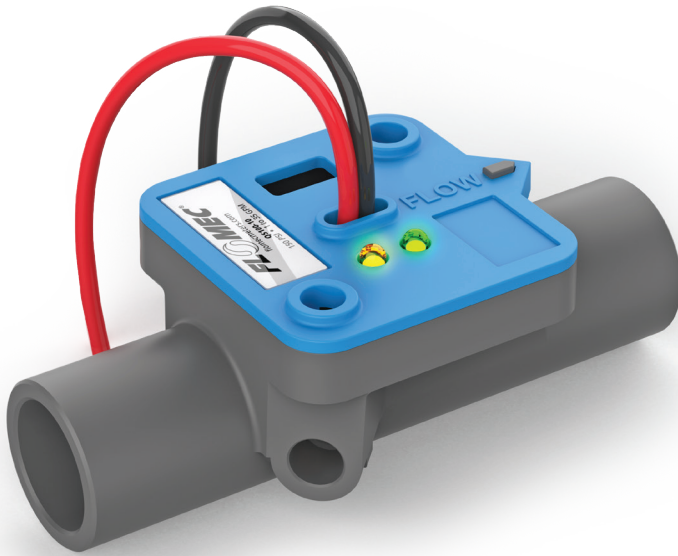

FEATURES / BENEFITS

- High accuracy: +/-2% of reading (compared to full scale on most other brands)
- Flow range of 0.22 to 33 GPM so you can monitor all of your zones with a single meter
- No moving parts for maintenance-free operation
- Can be used in above or below grade installations for maximum versatility
- A simple two wire connection for pulse and power make installation easy
- LED light indicators visually display power and operational mode
- Onboard diagnostics simplify system maintenance by utilizing the LED indicators to show low flow and high flow
- Compatible with most irrigation controllers
- Wire leads have UL Style 116666 direct burial insulation to ensure durability
- The QS100 is suitable for use with reclaimed water for those environmentally sensitive applications

SPECIFICATIONS

Housing Material:	Schedule 80 PVC (Polyvinyl chloride)	
Coverplate Materials:	PC/ABS (Polycarbonate/Acrylonitrile Butadiene Styrene)	
Wetted Materials:	PVC (Polyvinyl chloride)	
Type:	Ultrasonic Flow Sensor	
Unit of Measure:	Controller Dependant	
Flow Rate:	0.22-33 GPM	
	0.83-124.92 L/min	
	0.1-15 ft/sec	
Accuracy:	+/- 2% of Reading	
Uncertainty:	0.04 GPM / 0.018 ft/sec	
Temperature Rating:		
Operating:	+32° F to +140° F (0° C to +60° C)	
Storage:	-40° F to +140° F (-40° C to +60° C)	
Max Working Pressure:	150 psi @ 70° F (10.3 bar @ 21° C)	
Field Calibration:	No	
Inlet / Outlet Connections:	1 in. Male Spigot	
Weight:	0.42 lbs. (0.19 kg)	
Electrical:		
Powered By:	DC power provided by customer controller 7.5V (dc) min to 36V (dc) max	
	OFF State Current	200µA (Typical)
	OFF State V-High	Supply Voltage - (OFF State Current × Supply impedance)
Transducer Excitation:	ON State Current	(Supply Voltage / (Supply impedance + 50Ω))
	ON State V-Low	ON State Current × 50Ω
Output Frequency:	0 to 100 Hz	
Output Pulse Width:	4 mSec (Approx.)	

APPLICATIONS

- Sub-Metering Applications:
 - » High Rise Tenant Buildings
 - » Apartment Complex
 - » Universities
 - » Commercial Businesses
 - » Processing Facilities
- Agriculture Irrigation
- Turf / Landscape Irrigation Systems
- Micro Irrigation Systems
- Groundwater Monitoring

APPROVALS

IP68



K-Factor Information:

FLOMEC ultrasonic meters use K-factor values for greater accuracy during calibration. These values are derived by calibrating the meters using NIST traceable instrumentation. The K-factor value for this meter is listed below.

IMPORTANT: The K-factor provided is for reference. Accuracy can be affected by plumbing configuration, fluid condition, adjoining pipe schedule, and entrapped air. Customers should always validate accuracy and adjust K-factor as needed using the K-factor adjustment menu of your controller.

Pipe Schedule	Typical ¹ K-Factor	Hydrawise® ² K-Factor (Litre/Pulse)	Rain Master® K-Factor	Offset	Reference	
					Pulses/Gal	Pulses/Litre
Sch 40	0.4211*	0.0266	115	0	142.5	37.6
Sch 80	0.3963**	0.0250	108	0	151.4	40.0

¹ Controller Brands: Baseline™, Calsense, Hunter®, HydroPoint® (WeatherTrak®), ©TUCOR, Rain Bird®, and Toro®. ² Hydrawise®HCC models only.

*Based on 142.5 pulses per gallon. **Based on 151.4 pulses per gallon.

DIMENSIONS

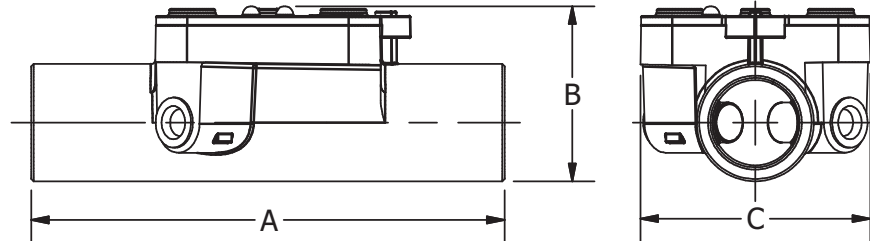

Length "A"	Height "B"	Width (at widest point) "C"
5.32 in. (13.5 cm)	1.96 in. (5.0 cm)	2.58 in. (6.6 cm)